

**FOSHAN SHINING LIGHTING TECHNOLOGY CO., LTD**

ADD: D factory, #10, Baihe Road, Nanhai Danzao Eco-Industrial Park Zip: 528216 W: <http://www.gledse.com/>  
T: 86-757-86780855 F: 86-757-86765036 M: +86 18927767560 Email: [sales@gledse.com](mailto:sales@gledse.com)

---

# PRODUCT SPECIFICATION



## ULTRA THIN LED PANEL LIGHT

**Model No: SL-PLS60120-72W**

### Customer Approval

Tested by	Checked by	Approved by

### SHINING Approval

Tested by	Checked by	Approved by

# FOSHAN SHINING LIGHTING TECHNOLOGY CO., LTD

ADD: D factory, #10, Baihe Road, Nanhai Danzao Eco-Industrial Park Zip: 528216 W: <http://www.gledse.com/>  
T: 86-757-86780855 F: 86-757-86765036 M: +86 18927767560 Email: [sales@gledse.com](mailto:sales@gledse.com)

## FACTORY PROFILE



### FOSHAN SHINING LIGHTING TECHNOLOGY CO., LTD

Our factory locates in Foshan NANHAI DANZAO Eco-Industrial Park, which covered an area of 5000 square kilometers. Our factory specialized in LED office lighting for more than 10 years of experience. We have two registered trademarks. One is **Gledse** for oversea market and other is  for domestic market.

The advanced production equipment, experienced technical personnel and the perfect quality management system bring us to dedicate to developing and producing the products to our customers. We have R&D team working on electric and appearance design. We also have our own metal workshop to deal with the OEM and ODM cooperation. We also accept the customized orders for different projects.

**Main products:** LED Ultra-thin panel light, LED back lit panel, LED smart panel light, LED linear light, LED tube, LED downlight, LED tracking light and LED light fittings.

The full ranges of our light fixtures are manufactured to our high specification with CCC, CE and RoHs compliant certification. Our products are exported to different countries and districts, such as Europe, US, Australia, Russia, Middle East etc.

Our intimate sales and after-sales team are always at your service and will take good care of our valued customers.

Our factory is near to Guangzhou area. It only takes about 1hr to our factory. Welcome to visit our factory at any time.

# FOSHAN SHINING LIGHTING TECHNOLOGY CO., LTD

ADD: D factory, #10, Baihe Road, Nanhai Danzao Eco-Industrial Park Zip: 528216 W: <http://www.gledse.com/>  
T: 86-757-86780855 F: 86-757-86765036 M: +86 18927767560 Email: [sales@gledse.com](mailto:sales@gledse.com)

## PRODUCT SPECIFICATION

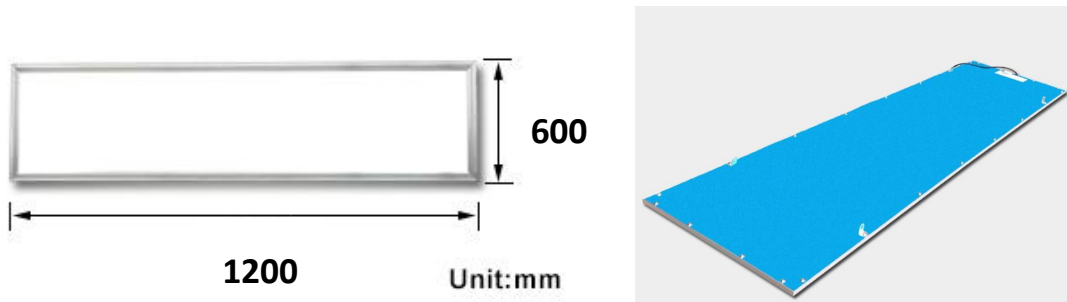

Quick Details			
Model No.	<b>SL-PLS60120-72W</b>	Input Vol.	AC220-240V;AC100-277V
Product size	600x1200x9 mm	Installation	Suspending/Recessed/Surface Mounted
Power	72W	PF	>0.9
Lumens	7200lm	CCT	WW3000K /NW4000K /CW6000K
IP Rating	IP20	Warranty	5 years
Material	6063AL+PMMA	Customized	Available
Dimming serve	DALI dimming、0-10V dimming、Bluetooth dimming、SCR dimming		

### 1. Features:

- (1)**Slim-light technology:** Back plate and Diffuser plate of to maintain a 9mm distance which is to avoid the phenomenon of the shadow.
- (2)**Aluminum housing:** Aluminum frames made from the strong anodizing aluminum profiles, high corrosion resistance, and high heat dissipation.
- (3)**Energy and cost saving:** It is saving 85% power compared with ordinary pendant light.
- (4)**Eco-friendly:** no ultraviolet and infrared radiation, no electromagnetic.
- (5)**High Electricity Utilization:** high photoelectric conversion rate.
- (6)**High Security Performance:** with constant gentle current, fast start, low voltage, low power consumption.
- (7)**Eye Protect:** no strobe flash, high color rendering, no felling tired even after long-term using eye.
- (8)**Professional Customization:** freely choose the specification what you like.
- (9)**Ultra-bright & energy efficient:** 100-110lm/w high output, much brighter than fluorescent, save more money on your energy bill
- (10)**Long lifespan:** 50000hrs, 5 times longer than fluorescent, reduce your replacement frequency and maintenance cost.5 years Warranty.

# FOSHAN SHINING LIGHTING TECHNOLOGY CO., LTD

ADD: D factory, #10, Baihe Road, Nanhai Danzao Eco-Industrial Park Zip: 528216 W: <http://www.gledse.com/>  
 T: 86-757-86780855 F: 86-757-86765036 M: +86 18927767560 Email: [sales@gledse.com](mailto:sales@gledse.com)

## 2. Construction:

**1 Aluminum Housing**  
 98% pure aluminum. Anodic oxidation treatment. Strong corrosion resistant material. Strong heat dissipation.

**2 Side-light technology**  
 PCB with large number of leds covers frame, Low thermal resistance. The light gives off soft, comfortable and no dazzle and ensured 100% no dark area. High rendering index performance and longer life.

**3 Professional LED Solution**  
 External drive, intelligent import IC chip, constant current drive power. Open circuit, short circuit, overvoltage protection, can be more stable, safer and longer life.

**4 Advanced LGP**  
 Advanced LGP with laser dotting Technology. Uniform distribution of light, high light transmission is up to 90%. Perfect lighting effect.

## 3. Installation:

**Recessed**



1 Remove the ceiling board



2 Connect the driver



3 Put panel light on the ceiling frame

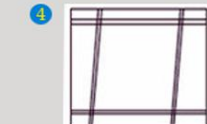

4 Power on

**Frame Mounting**

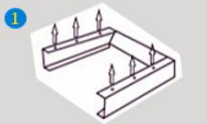

1 Screw ceiling frame on roof

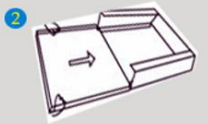

2 Pushing the panel into the frame



3 Fix panel light on the ceiling frame

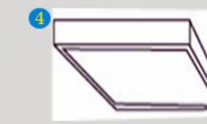

4 Power on

**Spring clip mounting**



1 Opening on the ceiling



2 Connect the driver



3 Open the clip and snap the panel light in the ceiling

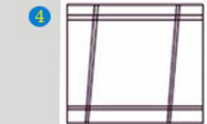

4 Power on

**Suspending**



1 Put the tap screw into the base and fix them onto the ceiling



2 Install four clips at two opposite edges of the panel

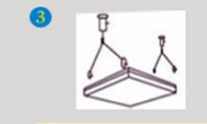

3 Lock the steel rope into the base and fix the hook into the four clips



4 Adjust the rope and power on



# FOSHAN SHINING LIGHTING TECHNOLOGY CO., LTD

ADD: D factory, #10, Baihe Road, Nanhai Danzao Eco-Industrial Park Zip: 528216 W: <http://www.gledse.com/>  
T: 86-757-86780855 F: 86-757-86765036 M: +86 18927767560 Email: [sales@gledse.com](mailto:sales@gledse.com)

## 4. Application:

Side-lit led panel light is widely applied to which traditional fluorescent lamps would normally be used. It appears in anyplace that needs light, such as factories, banks, hotels, stores, commercial buildings, shopping malls, super market and underground garage etc.



Shop



Classroom



Anteroom

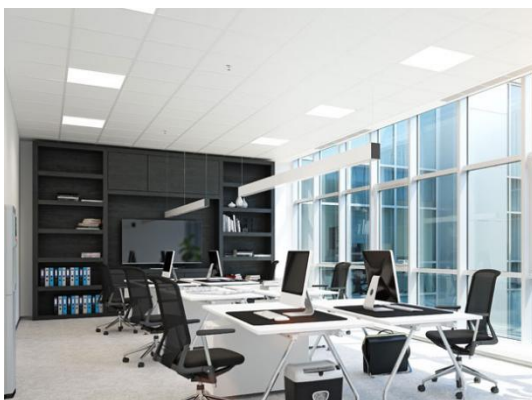

Office

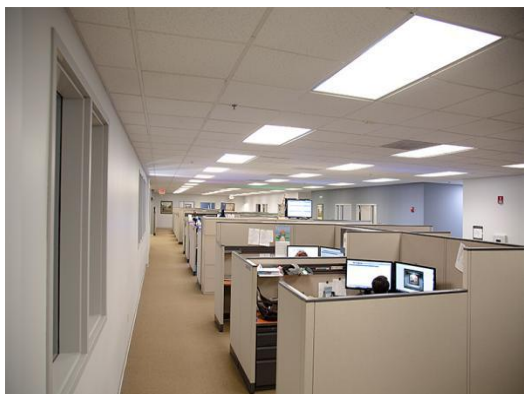

Corridor



Meeting Room

# FOSHAN SHINING LIGHTING TECHNOLOGY CO., LTD

ADD: D factory, #10, Baihe Road, Nanhai Danzao Eco-Industrial Park Zip: 528216 W: <http://www.gledse.com/>  
T: 86-757-86780855 F: 86-757-86765036 M: +86 18927767560 Email: [sales@gledse.com](mailto:sales@gledse.com)

## 5.Packaging information:

Model	Inner Carton Size (L*W*H cm)	Outer carton Size (L*W*H cm)	N.W. (kg)	G.W. (kg)	QTY/CTN (pcs)	20' GP (pcs)
SL-PLS60120-72W	-	125*8*66cm	8.8kg	19kg	2pcs	780pcs



Remark: The above packing information is only for reference.  
The platform or the plywood frame will be additional charged as per the package.

**For more detail information, please contact our Sales Representative. Thanks for your attention.**